

HeartFelt®

Modular felt
Ceiling system



reddot award 2017
best of the best

HunterDouglas 
Architectural



HeartFelt®

The Ceiling that *had* to be made

Design as a source of inspiration

Felt making has been a popular method of creating textiles for thousands of years. Felt's unique, tough structure and soft appearance means that designers continue to view felt as an intriguing material for clothing, furniture, fashion accessories and household items. Inspired by both felt and designers, Hunter Douglas Architectural created the ceiling that had to be made: HeartFelt®. A modular felt ceiling system with incredible acoustics and a unique appearance. A design that delights both eyes and ears and has sustainability at its core.

For improved learning, working and healthcare

HeartFelt® is an innovative, patented product that turns every ceiling into a visual and acoustic playground. The felt panels are available in seven beautiful grey shades and five magnificent earth tones which can be easily clipped into the carriers, at varying centres. This makes it possible to perfectly adapt the visual and functional properties of the ceiling to meet the needs of the Architect, Interior Designer or end user. HeartFelt® conforms to all the required building certifications and the European Indoor Environmental Standard (EN 15251). This makes the HeartFelt® ceiling system particularly suited to offices and other functional properties, schools and buildings used for healthcare services.



ACOUSTIC PROPERTIES	4
VISUAL PROPERTIES	5
HEARTFELT IN DETAIL	6-8
- PES FIBERS	
- COLOURS	
- EASY TO INSTALL	
- SUSPENSION	
- JOINING AND FINISHING	
- INTEGRATED TECHNOLOGY	
- CONSTRUCTION DETAILS	
SUSTAINABLE FEATURES	9
HUNTER DOUGLAS ARCHITECTURAL	10

HeartFelt® in a nutshell

- Modular ceiling system with felt panels
- Excellent acoustic properties
- Visually integrates the ceiling into the interior design
- 100% recyclable, sustainable material
- Patented product
- Patented manufacturing technology
- Cost effective
- Easy to maintain: dirt and dust resistant
- Certified:
 - European Indoor Environmental Standard EN 15251
 - C2C
 - Suitable for BREEAM and Leed
 - VOC emissions class A+, M1
 - Fire classification EN 13501-1 class B, s1, d0

HunterDouglas 
Architectural



Designed to work for you



ACOUSTIC PROPERTIES



The ceiling as an acoustic mixing board

With the HeartFelt® ceiling system, Hunter Douglas is providing architects, installers and building owners with an advanced system that allows them to precisely manage the acoustics of every space. Felt's sound-absorbing properties in combination with the design of the panels, the space between the panels and the height at which the ceiling system is hung, determine how sound moves throughout the space. HeartFelt® can help to create a pleasant workspace or learning environment and contribute to increased productivity.





The ceiling as a creative canvas

HeartFelt®'s linear felt ceiling panels are box-shaped and clip easily to the specially designed carriers. Since the panels are available in seven shades of grey, ranging from white to black, and five magnificent earth tones, interesting patterns

can be created. By varying the placement of the panels and the ceiling system, the ceiling is able to play a crucial role in the overall interior design.

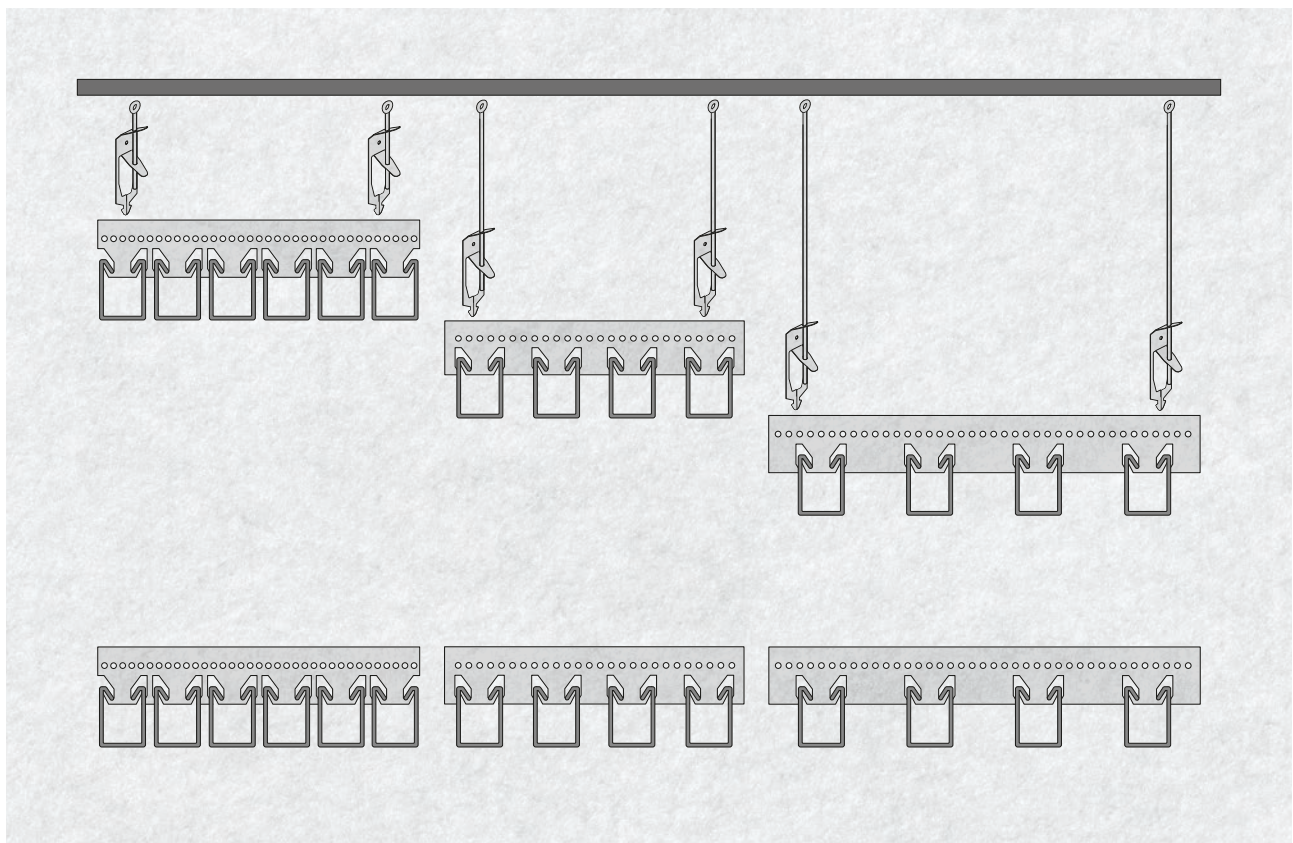

HeartFelt® in detail

PES fibers

HeartFelt® is a linear ceiling system with open joints made of non-woven thermoformed PES fibers. The panels are manufactured up to a maximum size of 40 mm in width and 55 mm in height. The following modules are available:

MODULE	JOINT WIDTH	OPENNESS %
100 mm	60 mm	60 %
90 mm	50 mm	55 %
80 mm	40 mm	50 %
70 mm	30 mm	43 %
60 mm	20 mm	33 %
50 mm	10 mm	20 %

The 100 mm module is suitable for use in buildings with concrete core activation (CCA).

Colours

HeartFelt® is available in seven grey shades, ranging from white to black and in five earth tones. The proportion of the white, black and coloured PES fibers determines the colour of the panels.

SHADES OF GREY

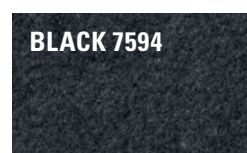
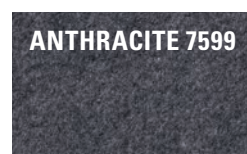
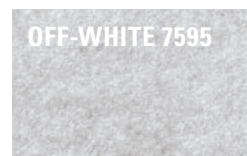
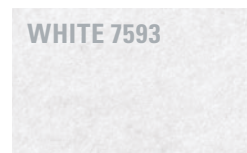

EARTH TONES

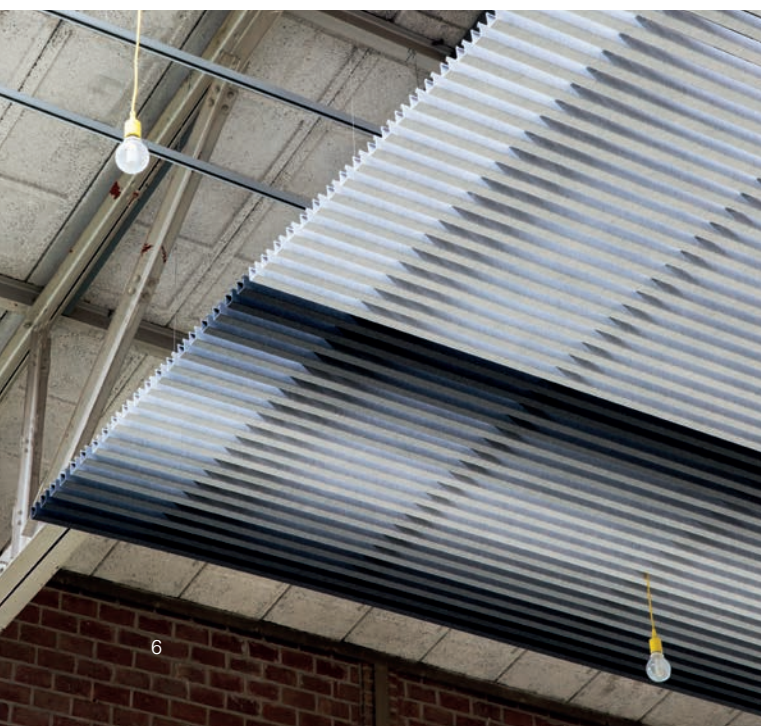
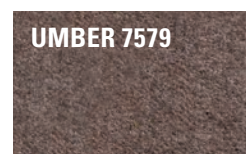
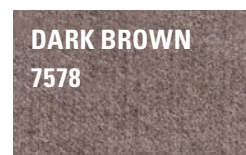
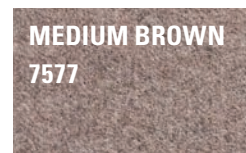
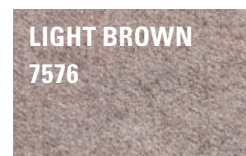
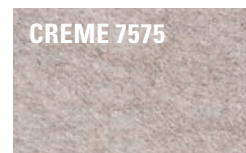

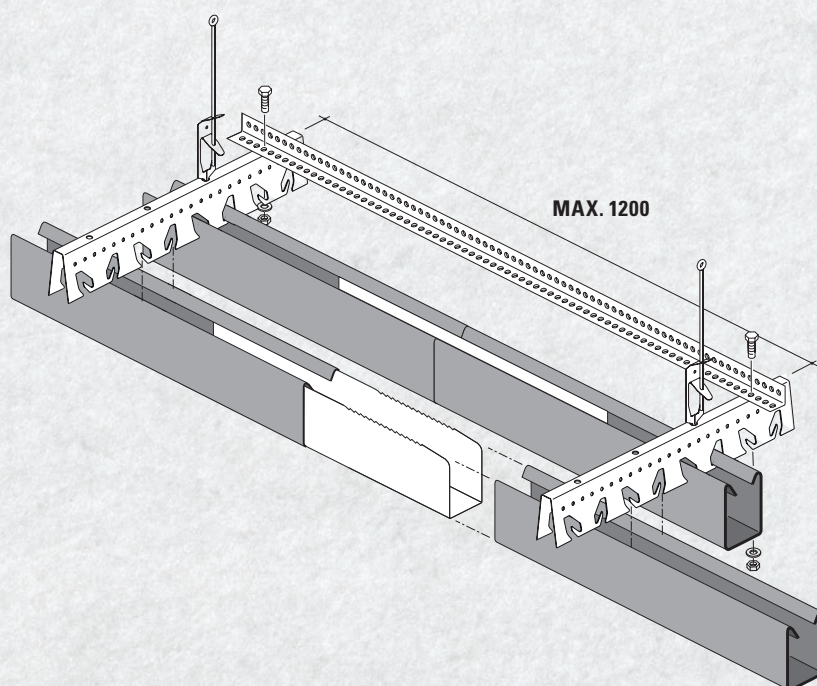

Ease of installation

The HeartFelt® ceiling system's felt panels are light and clip easily to the carriers. We can manufacture panels of any desired dimensions between 1 metre and 6 metres. If required, the panels can be trimmed with a sharp knife during installation.

Joining and finishing

The panels can be joined using a splice. The ends can be finished with an integrated end cap. This means that the HeartFelt® ceiling system can be installed both as a full ceiling and as a functional ceiling island.

Integrated technology

The HeartFelt® ceiling system's modular nature makes it possible to integrate technology such as lighting and ventilation. There is a reinforcement piece that can be inserted into the panels in order to attach objects such as signs.

Suspension

The carriers that the felt panels clip onto are made of coated aluminium and have a height of 52 mm. The total height of the system is 92 mm. The centre-to-centre distance between each carrier is 1200 mm, while the centre-to-centre distance between each hanger is 1500 mm.

Construction details

Cross-section of 50 mm module

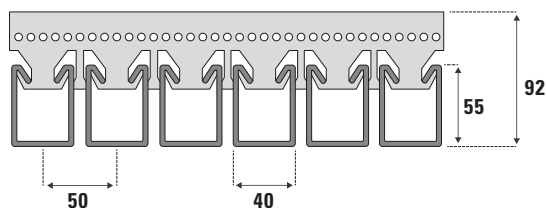

Cross-section of 70 mm module

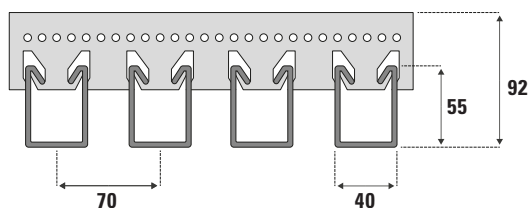

Cross-section of 100 mm module

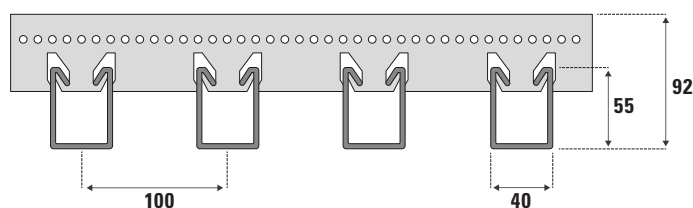

HeartFelt® material use per m² per module

	M50	M60	M70	M80	M90	M100
HEARTFELT PANEL 1	20.0 lm	16.7 lm	14.3 lm	12.5 lm	11.1 lm	10.0 lm
PANEL SPLICE *	4.00 pcs.	3.34 pcs.	2.86 pcs.	2.50 pcs.	2.22 pcs.	2.00 pcs.
CARRIER TYPE 1	0.83 lm	0.83 lm	0.83 lm	0.83 lm	0.83 lm	0.83 lm
CARRIER SPLICE	0.17 pcs.	0.17 pcs.	0.17 pcs.	0.17 pcs.	0.17 pcs.	0.17 pcs.
SUSPENSION HANGER	0.56 pcs.	0.56 pcs.	0.56 pcs.	0.56 pcs.	0.56 pcs.	0.56 pcs.

*Based on a panel length of 5000 mm

Acoustic values

MODULE	α _w	SAA
100 mm	0.45 (H)	0.44
90 mm	0.45 (H)	0.46
80 mm	0.50 (H)	0.50
70 (67) mm	0.60 (H)	0.55
60 mm	0.65 (H)	0.62
50 mm	0.70 (H)	0.70
70 (67) mm*	1.00 (H)	0.96
Closed	0.90 (H)	0

*with mineral wool

Light reflection

SHADES OF GREY	SOLAR	VIS
7593 (WHITE)	59.7 %	60.7 %
7595 (OFF-WHITE)	44.3 %	44.4 %
7596 (LIGHT GREY)	32.2 %	31.8 %
7597 (MIDDLE GREY)	20.3 %	20.6 %
7598 (DARK GREY)	8.9 %	8.5 %
7599 (ANTHRACITE)	6.1 %	5.8 %
7594 (BLACK)	3.6 %	3.5 %

EARTH TONES	SOLAR	VIS
7575 (CREME)	46.7 %	39.4 %
7576 (LIGHT BROWN)	33.8 %	28.3 %
7577 (MEDIUM BROWN)	24.1 %	17.5 %
7578 (DARK BROWN)	20.6 %	13.3 %
7579 (UMBER)	15.7 %	9.5 %



Ceilings as a sustainability standard

The linear felt ceiling panels that comprise HeartFelt® are made of non-woven, thermoformed PES fibers. No finishing coat is applied to the panels, making the panels 100% recyclable. The carriers (aluminium) and hangers (galvanised steel) are 100% recyclable.

C2C certification



- C2C Bronze certificate
- The product meets the 'Low' requirements for use in low-polluting buildings.

Cradle to Cradle Certified™ is a certification mark licensed by the Cradle to Cradle Products Innovation Institute.

Building certification

- VOC emissions class A+
- Suitable for BREEAM and Leed

VOC emissions



- BREEAM-Nor: approved
- M1: approved
- French regulations for CMR substances: approved

Easy to maintain

HeartFelt®'s linear felt ceiling panels are easy to clean with a duster or vacuum cleaner.

Designed to work for you

Hunter Douglas is a global player within the field of modern architecture. We understand the conflict between form and function better than anyone, and enrich the market with inspiring solutions that strengthen the aesthetic appeal of buildings and their functionality in terms of indoor climate, energy use and acoustics.

We develop clever and aesthetically appealing solutions in collaboration with architects and designers to control heat, light, sound and energy. We are also inspired by real-world challenges and ideas as well as developments in technology and materials. All our products are thought out in great detail to make a difference to both architects and end users.



© Registered trademark of Hunter Douglas - a HunterDouglas® product.
© Copyright Hunter Douglas 2018. No rights may be derived from the text or the illustrations or examples accompanying the text. Materials, parts, compositions, designs, versions, colours and the like may differ without prior warning. **MX004F00**



Printed on
EU Ecolabel-certified
paper



▲ Sun Louvres



▲ Ceilings

Façades ▼

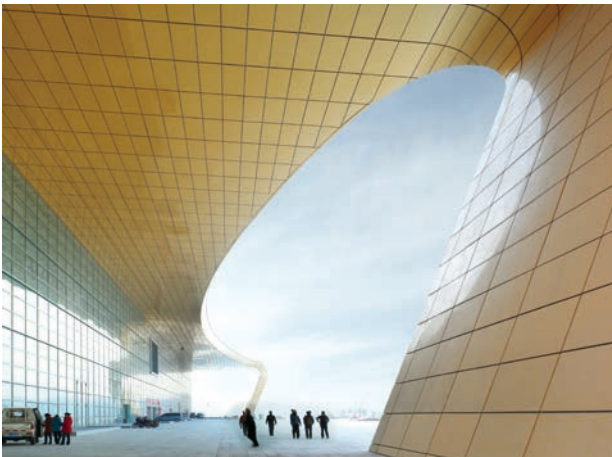

Architectural services

We support our business partners with a wide range of technical consulting and support services for architects and installers. We assist architects and developers with recommendations for materials, shapes and dimensions and colours and finishes. We also help create design proposals, visualisations and mounted drawings. Our services to installers range from providing detailed installation drawings and instructions to training installers and advice during installation.

More information

Would you like to know more about Hunter Douglas' services?

Contact our Sales Office:

+44 (0)1604 648 229

Visit our website:

www.hunterdouglas.co.uk

Hunter Douglas products and solutions are specifically designed to improve the indoor climate and save energy. They create an environment that is pleasant, healthy, productive and sustainable.



Hunter Douglas aims to produce sustainable products. Our painting and aluminium smelting processes are regarded as setting the bar for the most important standards in clean production methods. All aluminium products are 100% recyclable at the end of their lifecycle.



Ceilings

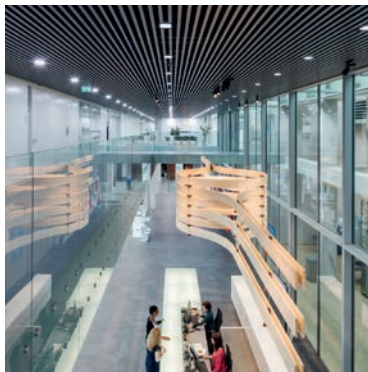

Sun Louvres



Façades



Belgium
Bulgaria
Croatia / Slovenia
Czech Republic
Denmark
France
Germany
Greece
Hungary
Italy
The Netherlands
Norway
Poland
Portugal
Romania
Russia
Serbia
Slovakia
Spain
Sweden
Switzerland
Turkey
United Kingdom
Africa
Middle East

Asia
Australia
Latin America
North America

Hunter Douglas Architectural United Kingdom

8 Charter Gate
Clayfield Close, Moulton Park
NN3 6QF Northampton
United Kingdom
Tel. +44 (0)1604 648 229
info@hunterdouglas.co.uk
www.hunterdouglas.co.uk